

NEW

Fan Speed Controllers

Type XGE

Keep condensing pressure constant in winter and intermediate seasons for stable operation.

**Contributing
to Energy Saving!!**



-Can make variable control with comparative ease-

-Suitable for controlling speed of fan motor in air-cooled condenser-

- Compact & Lightweight
- Installation is easy(Direct piping)
- CE mark applicable
- Wiring is easy(Four direction)

SAGHOMIYA

Specifications

Control method : Phase control

Max. working pressure : 4.7MPa

Power supply : [Rated Voltage] 230V.AC $^{+15}_{-20}$ % ~ single phase [Frequency] 50/60Hz [Rated Amp.] 0.2 to 3A

Pressure connection : 1/4" Female flare with Schrader(7/16-20 UNF)

Enclosure : IP65

Type Number Selection

Catalog No.	*1 F.V.S. Setting(MPa)		*2 E.P.B (MPa)	Refrigerants	Function	Ambient temp. (°C)	Fluid temp. (°C)	Wt. (kg)
	Factory Set	Adjusting Range						
	Min.	Max.						
XGE-4CC-7	1.9	1.0	2.5	0.6	R22,R407C,R404A	-20 to 55	-20 to 70	0.19
XGE-4MC-7								
XGE-6CC-7	2.8	2.2	3.9	0.7	R410A	-20 to 55	-20 to 70	0.19
XGE-6MC-7								

Cut off : Fan motor will be stopped when pressure decrease to the specific value(V%) for R.M.S.

Min. speed : Fan motor will be kept running at the specific value(V%) when pressure band increase more than E.P.B.

*1 F.V.S. : FULL VOLTAGE SET POINT

The pressure at which the control delivers 95% output effective voltage.

*2 E.P.B. : EFFECTIVE PROPORTIONAL BAND

Pressure width where effective voltage corresponds to the min. speed or causes cut off operation.

Operation

XGE-4CC-7 and XGE-6CC-7 (Cut off type)

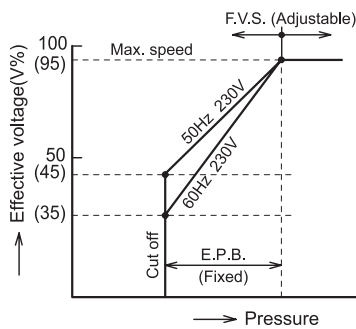

XGE-4MC-7 and XGE-6MC-7 (Min. speed type)

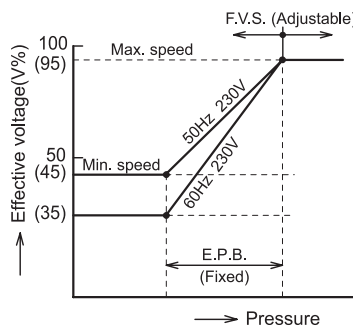

*The operating characteristic may vary according to the voltage, frequency, and fan motor characteristics.

Dimensions

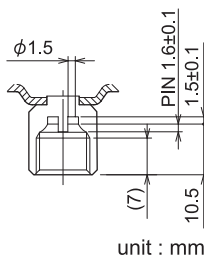
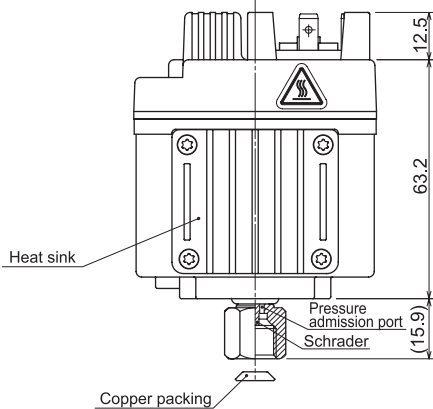
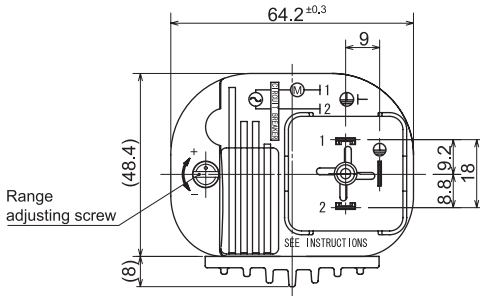

Wiring

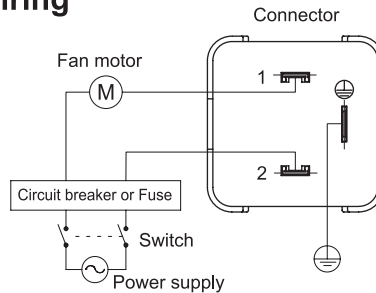

Supplied with a gasket. Cable exit in 4 directions possible.

Accessories (XGE-1 Plug parts set)

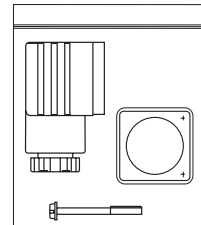

- Plug
- Gasket
- Plug fixing screw
- Plastic bag

NOTES FOR SAFETY

Failure to read and follow all instruction carefully before installing or operating the product could cause personal injury and/or property damage.

Specifications are subject to change without notice.

SAGINOMIYA SEISAKUSHO, INC.



TORONTO, ON
TEL: (905) 737-2113
FAX: (905) 737-7319

MONTREAL, QC
TEL: (514) 685-5113
FAX: (514) 685-5119

VERNON, BC
TEL: (250) 549-9162
FAX: (250) 549-9182

www.ecotherm.ca

1-866-HVACMAX (482-2629)

sales@ecotherm.ca